

Adding X,Y Coordinates to ArcMap

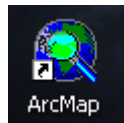

Step 1: Open your ArcMap project.



Step 2: Next click on Editor then Start Editing.

Step 3: Next right click on Layers then Properties... . Under the General Tab change Display: to Degree Minutes Seconds . Then click OK .

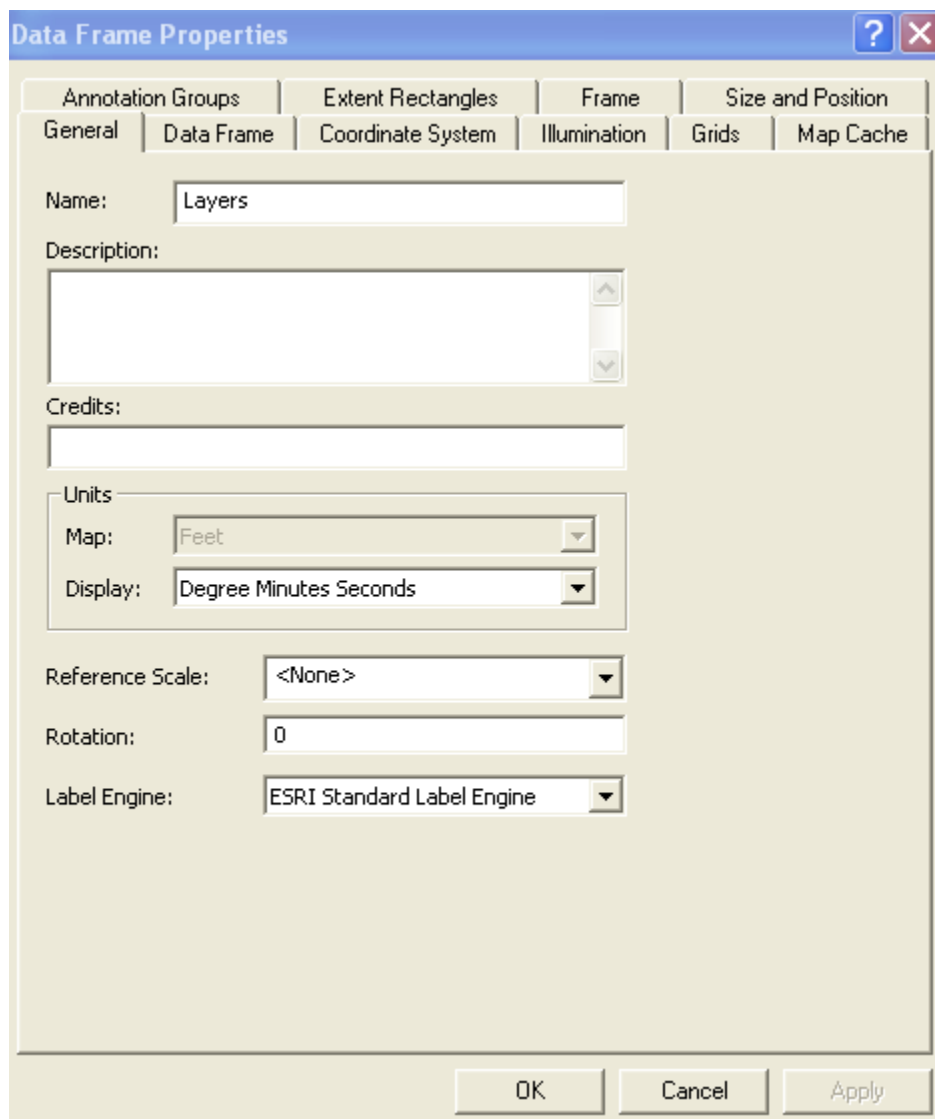

Manual: GIS SOP	Revised: January 8, 2008	Page 1
Authorized by: <i>Samuel Ross</i>	Title: GIS Tech II	

Adding X,Y Coordinates to ArcMap

Step 4: Your X,Y should now appear in the lower right hand side of the screen.

82°25'27.82"W 28°30'33.78"N

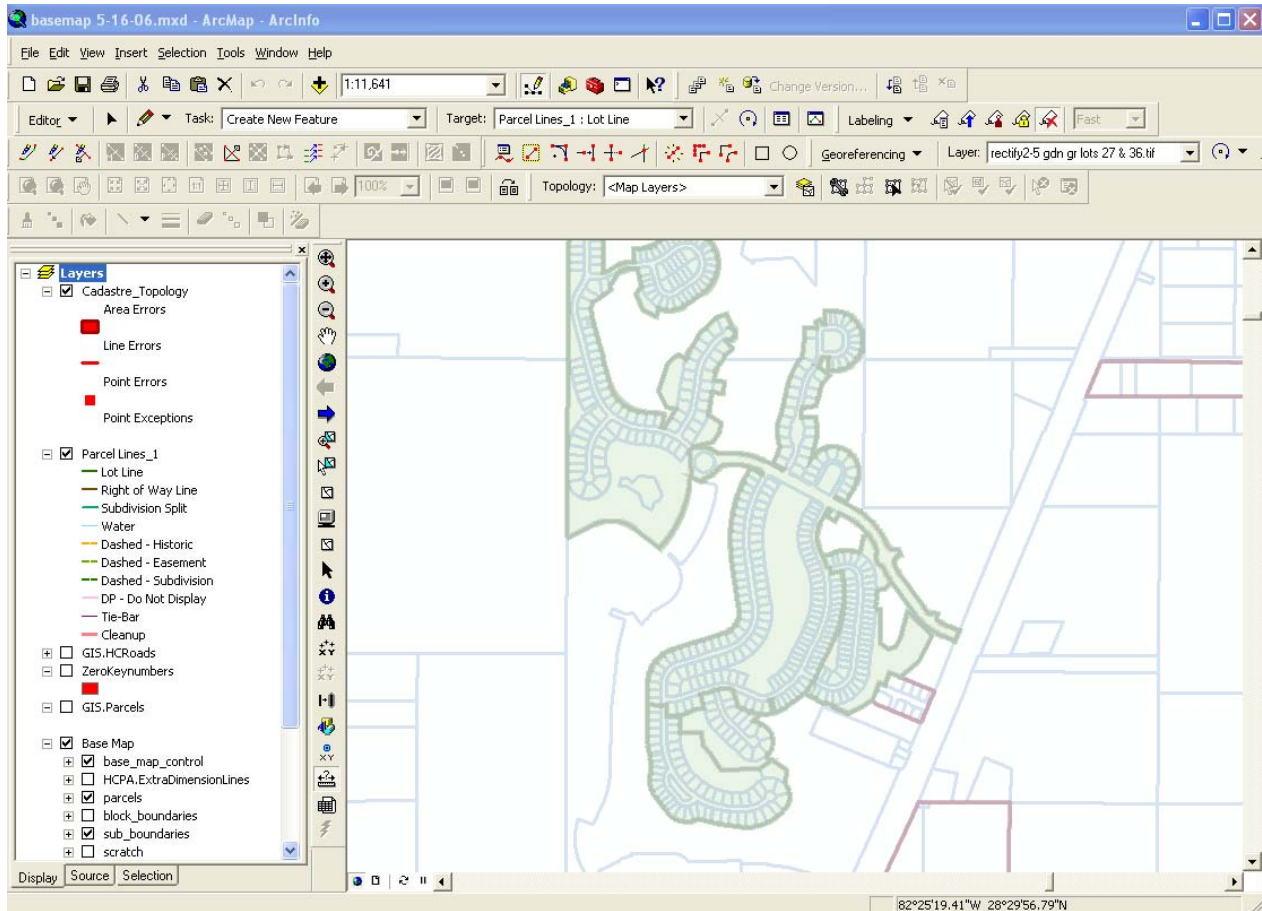

When you move your cursor over an object the box will reflect the correct coordinates.

This completes the process.

Manual: GIS SOP	Revised: January 8, 2008	Page 2
Authorized by: <i>Samuel Ross</i>	Title: GIS Tech II	